

DOUBLE DOOR-TYPE DISHWASHER

PDX PDX-1004 Series

POWERFUL
& EFFICIENT



PRODUCT ADVANTAGES

■ Double Capacity :

Double-wide wash chamber can wash 2 racks efficiently at once.

■ Double Rinse Pumps :

High-quality rinse pumps are installed at each side of the rinse tanks for better overall rinse quality.

■ "S-shaped" Stainless Wash Arms :

"S-shaped" stainless wash arms provide maximum hygiene by using high pressure jet nozzles and reaching corner blind spots.

■ Tempered Glass Window :

Washing and rinsing processes are observable through the tempered glass window to ensure dishware hygiene and machine operation.

■ 3 Heaters (Heating Elements) :

Total of 3 heaters are installed; 2 heaters in rinse tank, 1 heater in wash tank. This allows the water to be heated faster and maintain high temperature which enables the dishwasher to be used continuously.

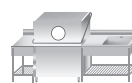

Straight-through (R → L)

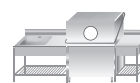

Straight-through (L → R)



Left Corner (R → L)



Right Corner (L → R)



RACK CONVEYOR ALTERNATIVE

Users who require heavy duty warewashing solution equivalent to rack conveyor dishwasher are highly recommended to use the double door-type dishwasher. This model does not require both left and right side sink and work tabling which can solve limited kitchen space problem. It can be also be installed in L-shaped corner configuration similar to regular door-type and wash twice the dishware capacity at once.

MODEL	PDX-1004 SERIES
TOTAL RATED LOAD	18.0 kW, 20.0 kW
ELECTRICAL RATING	380V, 50Hz, 3PH
CAPACITY (Racks, Plates)	100 /h, 3,000 /h
INLET OPENING HEIGHT	420 mm
CYCLE TIME	40~285 sec (Default: 117)
WASH & RINSE TEMPERATURE	65~70°C, 85~95°C
WASH & RINSE TANK	82 L, 38 L
HEATER	8.0 kW, 6.0 kW, 2.1 kW
RINSE WATER CONSUMPTION	6 L /min
DIMENSION (Outer)	1280 x 830 x 1385 mm



PDX-1004 DOUBLE DOOR-TYPE

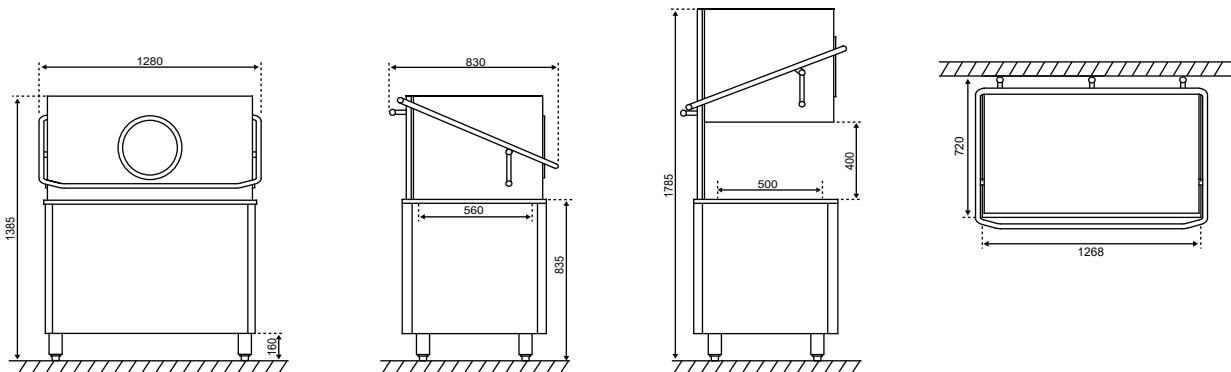

Dishwasher foot can extend from 155 mm to 185 mm. Maximum door cap opening height is 400 mm.

